

HF 310 TIMBER/ALUMINIUM WINDOW

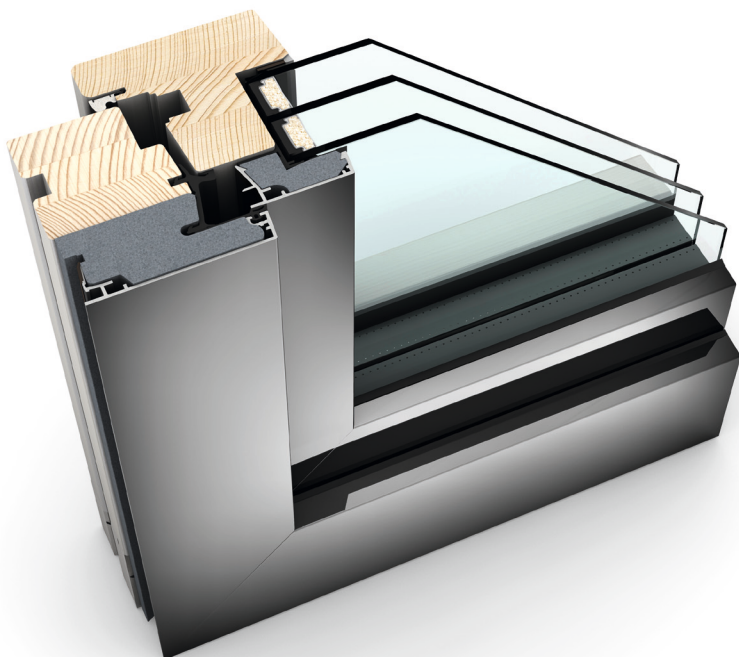

CHARACTERISTICS

Thermal insulation
(in W/m²K)



U_w as low as 0.62

Sound reduction
(in dB)



up to 46

Security



up to RC2

Locking



concealed

Construction depth
(in mm)



85

I-tec Glazing

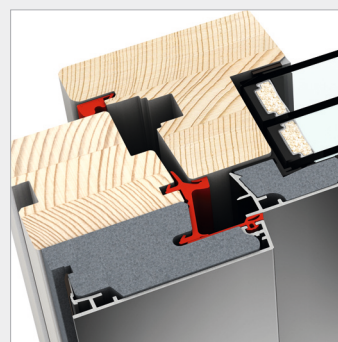
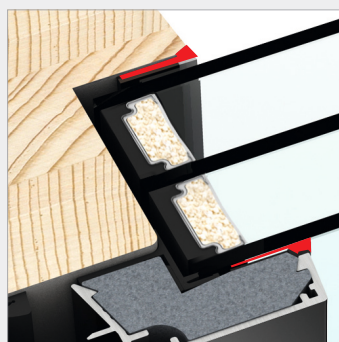
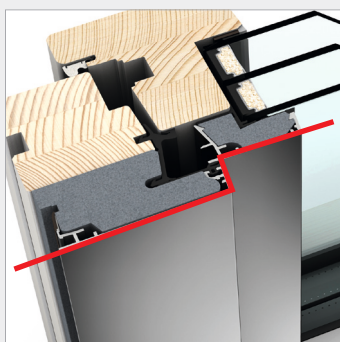

HF 310

HF 310 ensures more living comfort not only because of its interior timber surface. Highly thermally insulating thermal foam which is situated between the timber on the inside and the square-edged aluminium clad on the outside, ensures excellent thermal insulation. All around bonding of the glass pane to the window frame makes HF 310 burglary proof and stable. Three continuous gaskets prevent water entering on to the timber surface.

Sections

Vertical

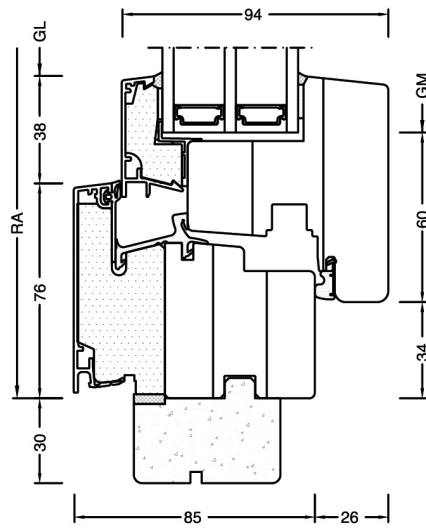

Horizontal

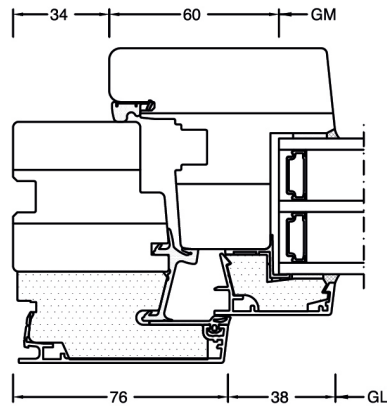

Flying mullion

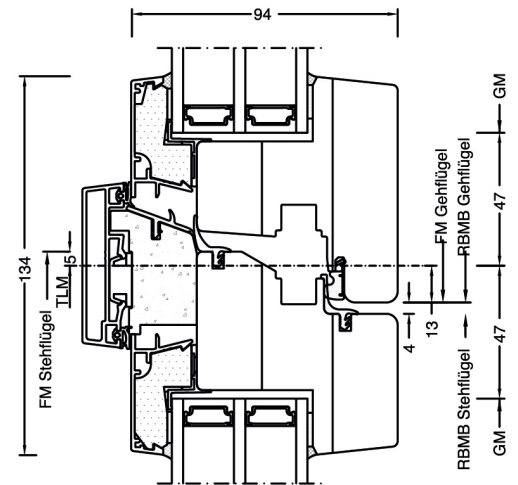

Construction connections

Putzanschluss innen und
Vollwärmeschutz außen.
Unterer Anschluss mit Alu-Sohlbank.

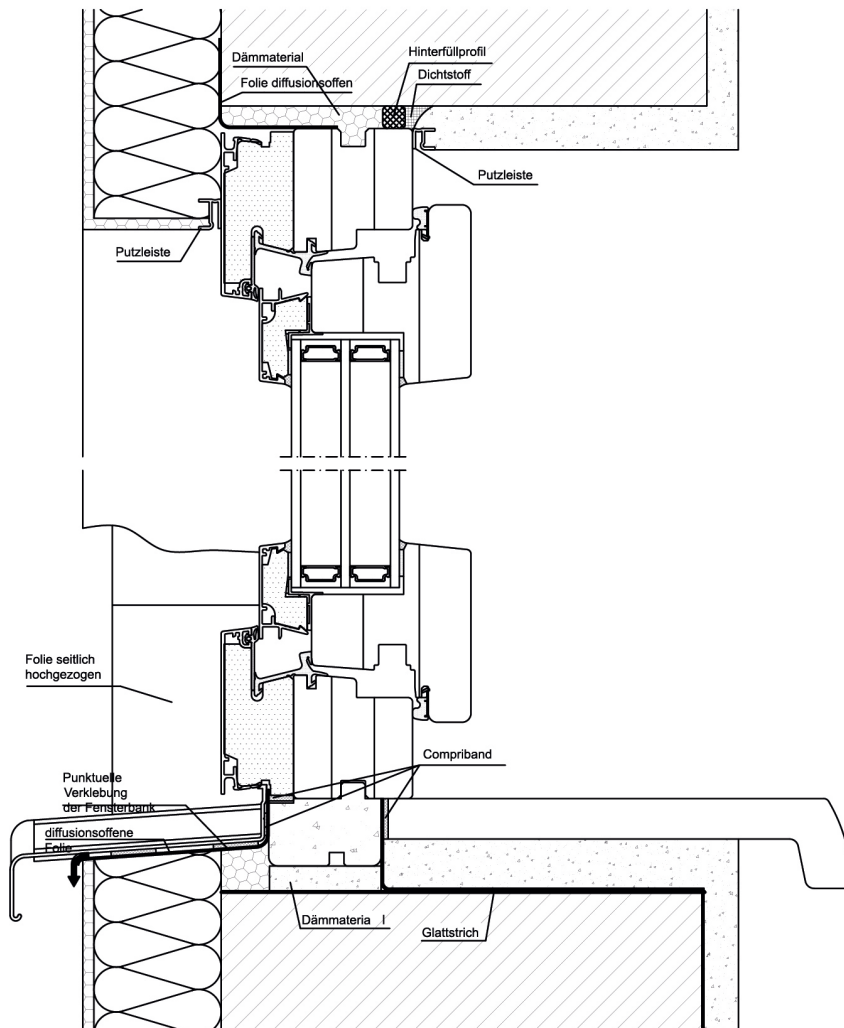

ATTENTION! Depicted drawing is symbolic only. Please observe national fitting guidelines such as ÖNORM B5320 in its respective valid version.

Bauanschluss
mit Alu-Bodenschwelle 30mm.

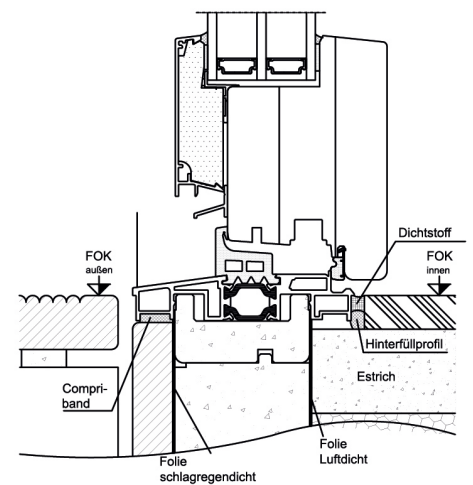

Bauanschluss
mit Purenitprofil unten

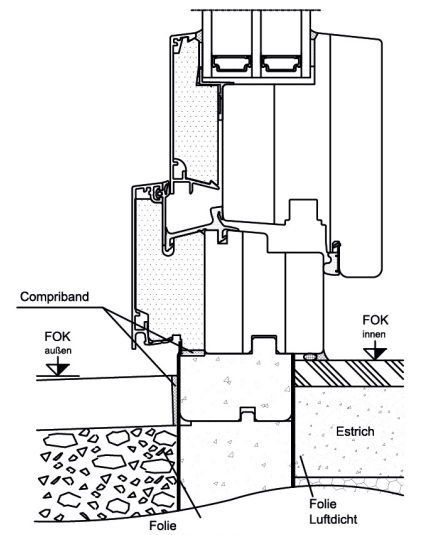

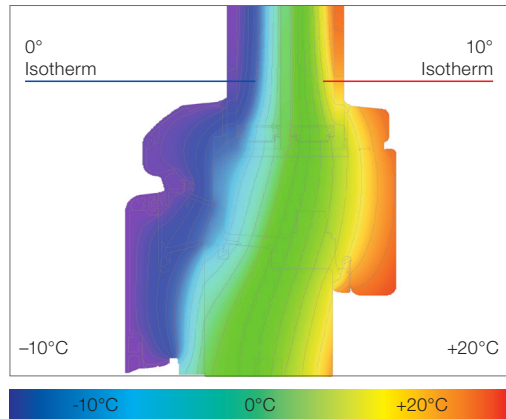

Optimal isotherm gradient to ensure low amounts of condensation

Due to the deep glass position, tremendous construction depth and the directly glued window panes glazing LIGHT ($U_g = 0.5 \text{ W/m}^2\text{K}$) can achieve a sensational U_w value of $0.69 \text{ W/m}^2\text{K}$ (with ISO spacer).

Technical information

- Timber frame with double peg connection
- Aluminium profiles cut to mitre, held in place with UPVC and aluminium brackets and bonded full-surface
- Anodised colours, RAL colours, highly weather-resistant structure, metallic and timber decor colours available for outside aluminium
- 11 standard colours for timber inside – RAL and NCS available
- 3 gasket levels all around – EPDM and Q-LON gaskets
- Glass thicknesses 48 mm
- Glass panes glued all around and sealed with clear silicone

System	Glass set-up	Glass code	Spacer	Coating	U _g	U _f	Psi	U _w	Thermal cert.	R _w	C	C _{tr}	Sound cert.
HF310	4b/18Ar/4/18Ar/b4	3N2	Iso	light	0.5	0.86	0.033	0.69	YES	35	-1	-4	YES
				SolarXPlus	0.5	0.86	0.033	0.69*	NO				
			Alu	light	0.5	0.86	0.072	0.79	YES				
				SolarXPlus	0.5	0.86	0.072	0.79*	NO				
	6b/18Ar/4/16Ar/b4	33U	Iso	light	0.5	0.86	0.036	0.77	YES	39	-1	-5	YES
				SolarXPlus	0.5	0.86	0.036	0.77*	NO				
			Alu	light	0.5	0.86	0.079	0.88	YES				
				SolarXPlus	0.5	0.86	0.079	0.88*	NO				
	44b.2(VSG-S)/15Ar/ 4/12Ar/ b44.2(VSG-S)	3FH	Iso	light	0.7	0.86	0.047	0.87	YES	46	-1	-5	YES
				SolarXPlus	0.7	0.87	0.047	0.87*	NO				
			Alu	light	0.7	0.86	0.092	0.98	YES				
				SolarXPlus	0.7	0.87	0.092	0.98*	NO				
	4b/16Ar/4/15Ar/ b44.2 (VSG-S)	34N	Iso	light	0.6	0.86	0.036	0.77*	NO	42	-2	-5	YES
				SolarXPlus	0.6	0.86	0.036	0.77*					
			Alu	light	0.6	0.86	0.079	0.88*					
				SolarXPlus	0.6	0.86	0.079	0.88*					

Test certificates in **ambiente** - values for **home pure** and **studio** are identical

Internorm Window UK

Unit D, Colindale Business Park
2-10 Carlisle Road, NW9 0HN, London
Tel.: +44 (0) 208 205 9991

Email: office@internorm.co.uk