

TM
77
HI

HIGH THERMAL INSULATION PROPERTIES

TM 77HI - SYSTEM FEATURES

TM 77HI system is a safe and innovative solution that provides excellent parameters of thermal and acoustic insulation, safety, and protection against wind and water.

The separators between aluminium profiles ensure great thermal insulation properties.

Dedicated thermal insulators act as thermal insulation, in combination with infill of high thermal insulation properties.

Photo: Corner House, Warsaw
Design: Biuro Projektów Kazimierski i Ryba Sp. J., Warsaw
Aluminium manufacturer: BUMA FACTORY, Cracow



ADVANTAGES OF THE SYSTEM

- possibility of heating costs reduction,
- possibility of creating large-surface constructions with modern arrangement of facades and interiors,
- easy to match with fittings elements and control elements,
- possibility of creating modern constructions of various shapes and configurations,
- possibility of achieving heat transfer factor as good as $U_f = 0,8 \div 1,5 \text{ W/m}^2\text{K}$ thanks to using unique thermal insulation solutions,
- possibility of making balcony door with low threshold,
- possibility of combination with other Yawal systems.

CROSS SECTION OF WINDOW TM 77HI

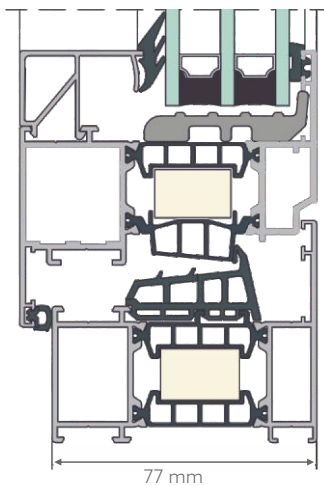

CROSS SECTION OF LOW THRESHOLD WINDOW TM 77HI

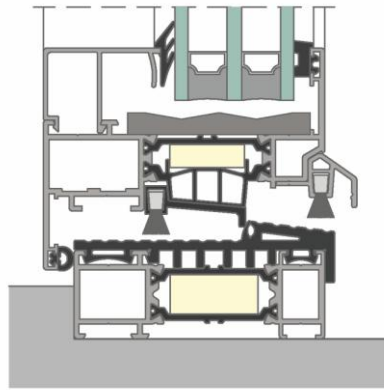

CROSS SECTION OF DOOR THRESHOLD

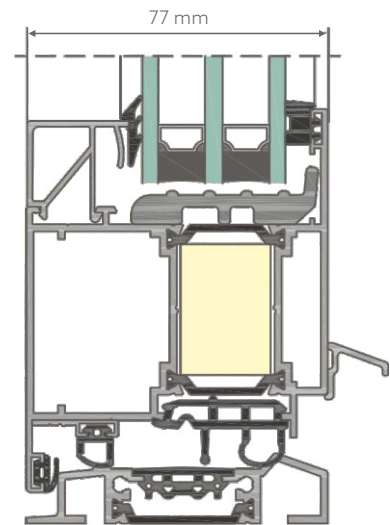

TECHNICAL PARAMETERS - TM 77HI

	TM 77HI windows	TM 77HI doors
Air permeability	class 4 acc. to PN 12207	class 4 acc. to PN-EN 12207
Water tightness	E1650 acc. to PN-EN 12208	E900 acc. to PN-EN 12208
Heat transfer coefficient	$U_f = 0,8 \div 1,4 \text{ W/m}^2\text{K}$ acc. to PN-EN ISO 10077-2	$U_f = 0,9 \div 1,5 \text{ W/m}^2\text{K}$ acc. to PN-EN ISO 10077-2
Acoustic insulation	39-48 dB acc. to PN-EN ISO 140-3	36-45 dB acc. to PN-EN ISO 140-3
Anti-theft protection	RC2, RC3, RC4	RC2, RC3

SYSTEM CHARACTERISTICS

Window structural depth	Frame profile	77 mm
	Sash profile	86,4 mm
Door structural depth	Frame profile	77 mm
	Sash profile	77 mm
Glass pane thickness for windows	Frame profile	19÷61 mm
	Sash profile	28÷67 mm